

\*Front Jack socket on black E50 only.

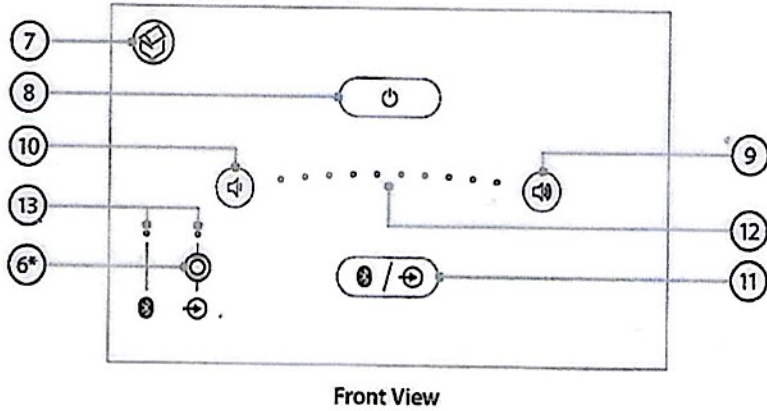

Front View

### Front panel connections\*

6. Analogue audio - line in\*  
Connect an analogue audio input here using a stereo 3.5mm jack cable such as QED Performance J2J. A green LED means this input is active.

### Front panel controls

7. Standby indicator  
Illuminates red to indicate the unit has entered standby.
8. Standby/on key  
Touch here to toggle the unit on or off.
9. Volume up key  
Touch here to increase the volume.
10. Volume down key  
Touch here to decrease the volume.
11. Source key  
Touch here to toggle between *Bluetooth* and line-in sources.
12. Volume position array  
Provides a visual indication of current volume setting. A single pulsing LED means mute. Auto dims after 10s. Touch here to toggle play/pause when in *Bluetooth* mode.
13. Indicator LEDs  
Blue = *Bluetooth*, Green = Analogue In

5

### To put the E50 into standby

1. Press the *standby* key. The E50 will turn off and the red LED will illuminate. In this mode the amplifier is turned off and the *Bluetooth* connection is dropped. The E50 is still in *Bluetooth pairing mode* and will wake instantly when the *standby* key is pressed or when paired.

### To put the E50 into deep standby

1. Press and hold the *standby* key until the red LED is extinguished. In this mode the amplifier and the *Bluetooth* pairing are turned off and the unit will consume only 0.5W of power.
2. When the *standby* key is pressed the unit will reboot to standby mode as above.

## VILLAGE HALL SOUND SYSTEM INSTRUCTIONS

PLEASE DO NOT REMOVE FROM HALL

BLUETOOTH NAME: SYSTEMLINE E50

## Operating Instructions

### Pairing a *Bluetooth* music source

1. To connect a new *Bluetooth* device you must put E50 into pairing mode.
2. Turn the E50 on by pressing the *standby* key. E50 will turn onto its Aux input, with the green LED on.
3. Press and hold the source key on the E50 until the blue LED starts flashing. You now have 60 seconds to pair a new *Bluetooth* device.
4. Select *Systemline E50* on your device. E50 unit will now pair and connect, and will switch to the *Bluetooth* input.
5. If the device has previously been paired it will connect straight away without the need for steps 2 and 3.

### Connecting a paired *Bluetooth* music source

1. You can simply connect a previously paired device to E50 at any time, even when the unit is in standby, unless another device is already connected.
2. If another device is connected, you can disconnect this device by putting E50 into standby.

### Listening to a *Bluetooth* music source

1. If not already done, pair or connect with the *Bluetooth* device (see above).
2. Navigate to the media player on your phone or other *Bluetooth* transmitter device and press *play*. The *Bluetooth* source will be selected and music will play through the E50.
3. Check that the blue source LED is illuminated, if not press the *source* key on the E50. The LED will turn from green to blue and the default volume level will be displayed.

### To skip track forwards in *Bluetooth* mode

1. Use your four outstretched finger tips to flick from left of the *volume down* key to right of the *volume up* key in a single consistent sweeping motion from left to right at a distance of up to 70mm from the front panel. Do not actually touch the front panel. The track will skip forward.

### To skip track back in *Bluetooth* mode

1. Use your four outstretched finger tips to flick from right of the *volume up* key to left of the *volume down* key in a single consistent sweeping motion from right to left at a distance of up to 70mm from the front panel. Do not actually touch the front panel. The track will skip back.

6

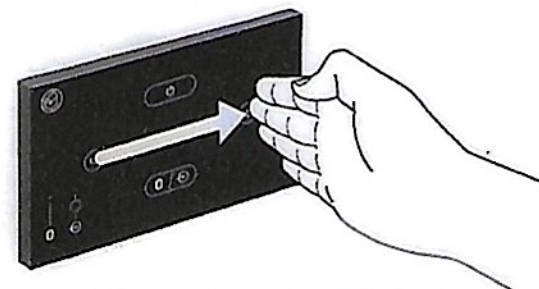

Skip track forwards using hand gesture

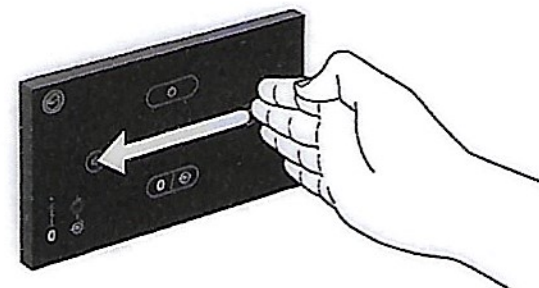

Skip track back using hand gesture

### To pause/play in *Bluetooth* mode

1. Touch the centre of the touch panel where the volume LEDs are positioned to pause playback while in *Bluetooth* mode.
2. Touch the centre of the touch panel again to resume playback.

### Listening to an analogue music source

1. Make sure that a compatible analogue music source is connected to either the front or rear input jack (not both) using a 3.5mm stereo audio jack cable.  
*Do not connect audio sources to the front and rear line inputs at the same time.*
2. Check that the green source LED is illuminated. If not, press the *source* key. The green LED will be illuminated and the default turn on volume level will be indicated.

7



### To adjust the volume

1. Touch the *volume up* key to increase the level of the music, and touch the *volume down* key to reduce it.
2. The same functionality can be achieved using a convenient gesture control.
3. Use your index finger to describe a circular pattern within the confines of the four touch key symbols at a distance of up to 70mm from the front panel. Do not actually touch the front panel. A clockwise rotation will increase the volume level and an anti-clockwise rotation will decrease the volume level.

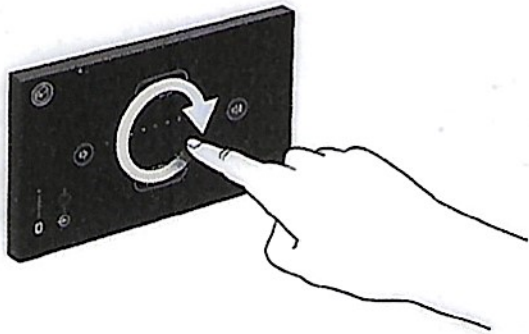

Increase volume using hand gesture

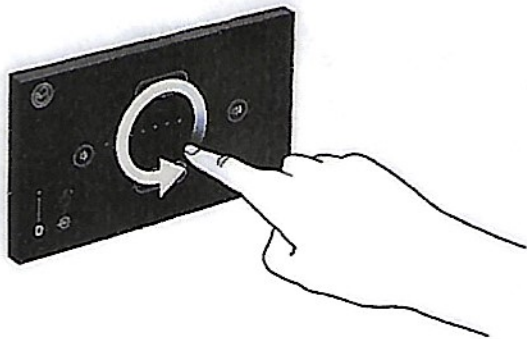

Decrease volume using hand gesture

8

### To mute the volume

1. Use your four outstretched finger tips to flick from above the *standby* key to below the *source* key in a single consistent sweeping motion from top to bottom at a distance of up to 70mm from the front panel. Do not actually touch the front panel.
2. The music will mute and the white volume LED will gently pulse. In *Bluetooth* mode the music will also be paused.

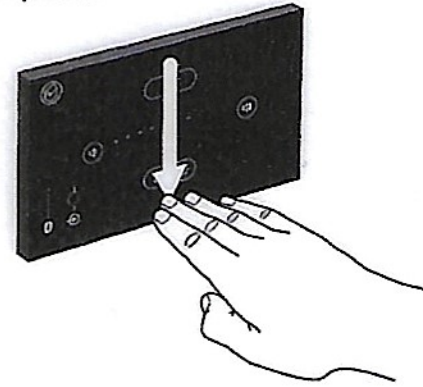

Mute using hand gesture

### To unmute the volume

1. Use your four outstretched finger tips to flick from below the *source* key to above the *standby* key in a single consistent sweeping motion from bottom to top at a distance of up to 70mm from the front panel. Do not actually touch the front panel.
2. The music will unmute and the volume display will return to the previous setting. In *Bluetooth* mode the music will also be unpaused.

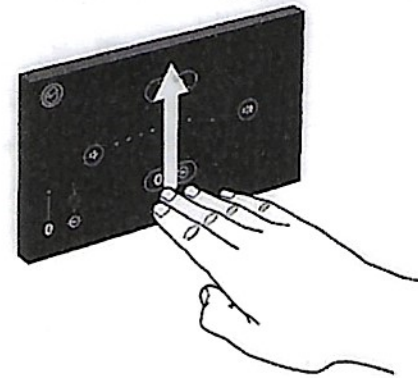

Unmute using hand gesture

9